

# CPC-HRC45 - Linear Guides

DIMENSIONS

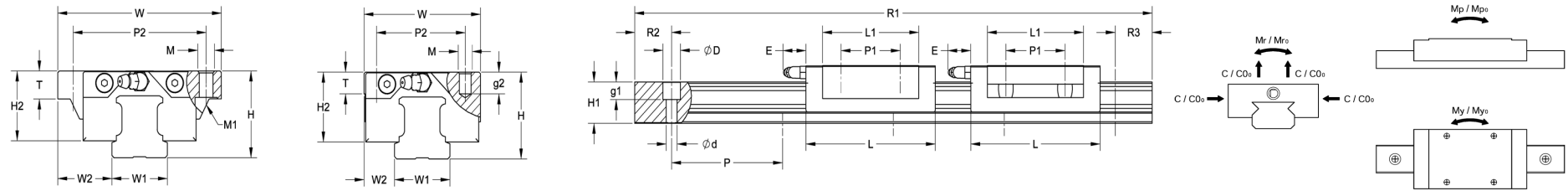

SPECIFICATIONS

Block Part Number	Fabrication Dimensions (mm)		Block Dimensions (mm)										Load Capacities (KN)		Static Moment (Nm)			Weight (lbs)
	H	W <sub>2</sub>	W	L	L <sub>1</sub>	h <sub>2</sub>	P <sub>1</sub>	P <sub>2</sub>	E	Mxg <sub>2</sub>	M <sub>1</sub>	T	C	C <sub>0</sub>	Mr <sub>0</sub>	Mp <sub>0</sub>	My <sub>0</sub>	
CPC-HRC45MNBZV0N	70	20.5	86	135.5	102.5	60.7	60	60	14	M10x20	-	14	71.3	122.1	3200	1910	1910	6.2
CPC-HRC45MNSZV0N	70	20.5	86	135.5	102.5	60.7	60	60	14	M10x20	-	14	71.3	122.1	3200	1910	1910	6.2
CPC-HRC45MLBZV0N	70	20.5	86	171.5	138.5	60.7	80	60	14	M10x20	-	14	89.5	169.1	4430	3460	3460	9.0
CPC-HRC45MLSZV0N	70	20.5	86	171.5	138.5	60.7	80	60	14	M10x20	-	14	89.5	169.1	4430	3460	3460	9.0
CPC-HRC45FNBZV0N	60	37.5	120	135.5	102.5	50.7	80	100	14	M12x15	M10	15	71.3	122.1	3200	1910	1910	11.6
CPC-HRC45FNSZV0N	60	37.5	120	135.5	102.5	50.7	80	100	14	M12x15	M10	15	71.3	122.1	3200	1910	1910	11.6
CPC-HRC45FLBZV0N	60	37.5	120	171.5	138.5	50.7	80	100	14	M12x15	M10	15	89.5	169.1	4430	3460	3460	16.5

Rail Part Number	Rail Dimensions (mm)									Weight (lbs)
	W <sub>1</sub>	H <sub>1</sub>	P	D	d <sub>i</sub>	g <sub>i</sub>	R <sub>1</sub>	R <sub>2</sub>	R <sub>3</sub>	
CPC-AR45N-300-45-45	45	39	105	20	14	17	300	45	45	6.96
CPC-AR45N-500-40-40	45	39	105	20	14	17	500	40	40	11.61
CPC-AR45N-700-35-35	45	39	105	20	14	17	700	35	35	16.25
CPC-AR45N-900-30-30	45	39	105	20	14	17	900	30	30	20.89
CPC-AR45N-1100-25-25	45	39	105	20	14	17	1100	25	25	25.54
CPC-AR45N-1300-20-20	45	39	105	20	14	17	1300	20	20	30.18
CPC-AR45N-1500-15-15	45	39	105	20	14	17	1500	15	15	34.82
CPC-AR45N-1700-10-10	45	39	105	20	14	17	1700	10	10	39.47
CPC-AR45N-1900-5-5	45	39	105	20	14	17	1900	5	5	44.11
CPC-AR45N-2100-52.5-52.5	45	39	105	20	14	17	2100	52.5	52.5	48.75
CPC-AR45N-2300-47.5-47.5	45	39	105	20	14	17	2300	47.5	47.5	53.39
CPC-AR45N-2500-42.5-42.5	45	39	105	20	14	17	2500	42.5	42.5	58.04
CPC-AR45N-2700-37.5-37.5	45	39	105	20	14	17	2700	37.5	37.5	62.68
CPC-AR45N-2900-32.5-32.5	45	39	105	20	14	17	2900	32.5	32.5	67.32
CPC-AR45N-3100-27.5-27.5	45	39	105	20	14	17	3100	27.5	27.5	71.97
CPC-AR45N-3300-22.5-22.5	45	39	105	20	14	17	3300	22.5	22.5	76.61
CPC-AR45N-3500-17.5-17.5	45	39	105	20	14	17	3500	17.5	17.5	81.25
CPC-AR45N-3700-12.5-12.5	45	39	105	20	14	17	3700	12.5	12.5	85.9
CPC-AR45N-3900-7.5-7.5	45	39	105	20	14	17	3900	7.5	7.5	90.53
CPC-AR45N-4000-L	45	39	105	20	14	17	4000	52.5	52.5	92.86

The rated load capacities and static moment values are calculated according to the ISO14728 standard. The rated life for basic dynamic load is defined as the total 100km travel distance that 90% of a group of identical linear guides can be operated individually under the same conditions, free from any material damage caused by rolling fatigue-When the standard of 50km travel distance is applied. The basic dynamic load rating C of ISO14728 should be multiplied by 1.26 for conversion.

Distributed by Anaheim Automation, Inc.  
 USA Stock in Anaheim, CA  
 1-800-345-9401  
 www.anaheimautomation.com